

TBS4

series

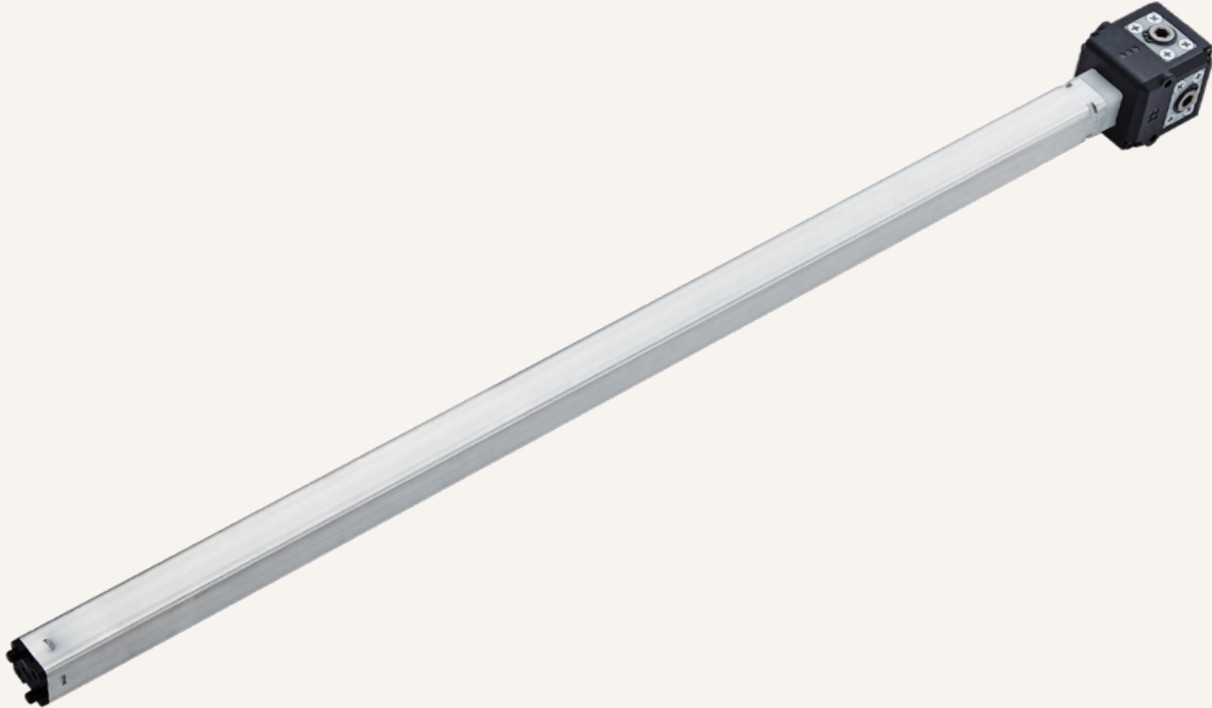

Product Segments

- **Ergo Motion**
- **Industrial Motion**

General Features

Recommended stroke	20~600mm
Minimum dimensions	≥ stroke + 120mm
Maximum load	500N

Drawing

Standard Dimensions
(mm)

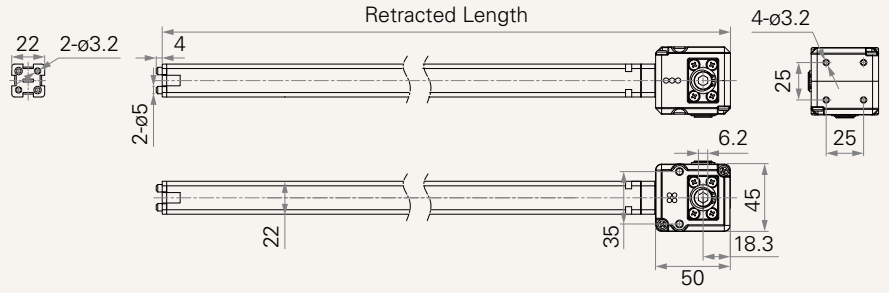

Load and Speed

CODE	Spindle (mm)	Lead (mm / turn)	Gear Ratio	Rated Load (N)	Rated Torque (Nm)	Typical Speed (mm/s)
C	3.9 (3.9Pitch*1)	3	13 / 17	500	11	RPM*3.9*13 / 17 / 60
D	12 (3Pitch*4)	9	13 / 17	500	2	RPM*12*13 / 17 / 60

Note

¹ Please refer to the approved drawing for the final authentic value.

Spindle Options	L = Left	R = Right		
Load and Speed	See page 2			
Stroke (mm)	20-600			
Retracted Length (mm)	Minimum retract length needs to $\geq S + 120$			
Input Torque (mm)	1 = Coupler hole, 6 See page 4			
Drive Shaft Hole-Shaft Type	1 = Gear = 1, A = C	2 = Gear = 1, B = D	3 = Gear = 2, AB = CD	4 = Gear = 2, AD = BC
Inner Tube Type (mm)	1 = Square tube, 22*22			
Front Attachment (mm)	1 = Plastic See page 4			

Input Torque (mm)

1 = Coupler hole, 6

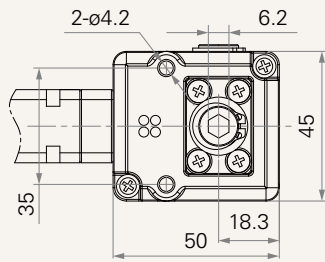

Front Attachment (mm)

1 = Plastic

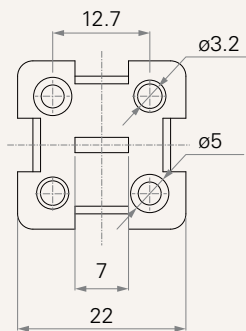

Terms of Use

The user is responsible for determining the suitability of TiMOTION products for a specific application. TiMOTION products are subject to change without prior notice.