

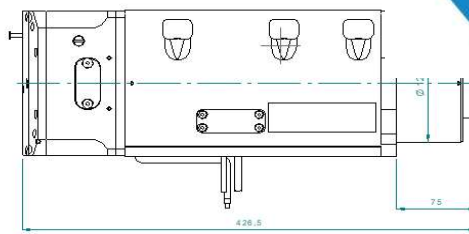

Electrospindle 24 kW 16000 rpm HT-2 25/4 16 63E NH ES

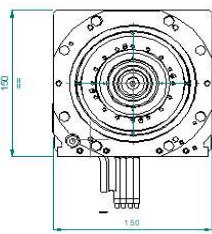

Prestazioni - Performances

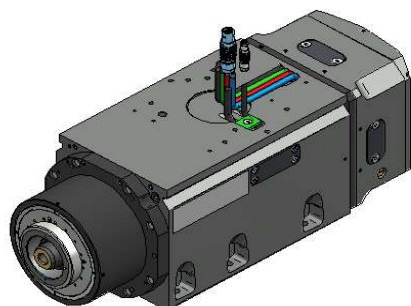
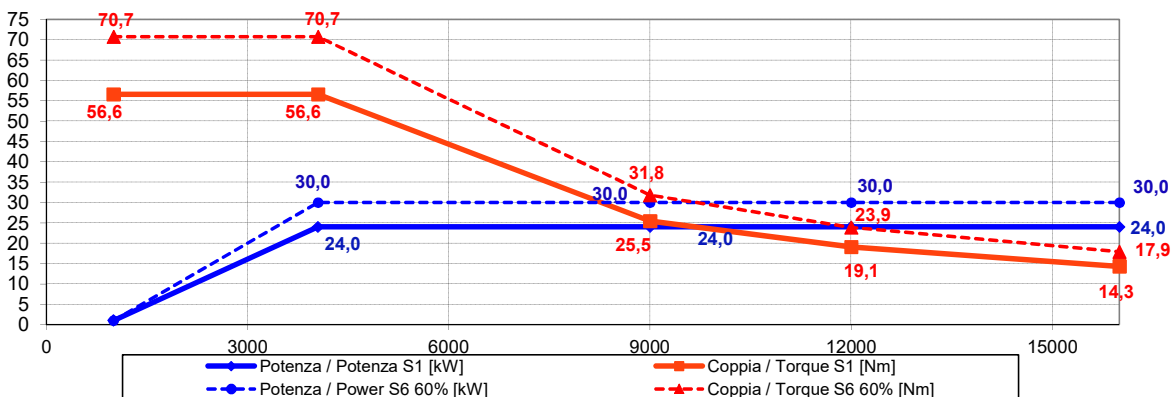

Specifiche tecniche/ Technical Specifications

Tipologia elettromandrino / Electrospindle type	Sincrono 8 poli / Synchronous 8 poles
Attacco utensile / Tool interface	HSK 63E
Velocità rotazione max / Max speed	16000rpm
Raffreddamento / cooling	Liquido/Liquid
Cuscinetti / Ball bearings	Ceramici / Ceramic
Lubrificazione cuscinetti / Bearings lubrication	Grasso a vita / Grease long life
Connessione pneumatiche / Pneumatic connection	Sblocco uten. / Release. tool: \varnothing 5 9.5-10.5 bar Pressurizzazione / Air seal.: \varnothing 5 4-4.5 bar Soffio cono/Taper clean.: \varnothing 5 4-4.5 bar
Potenza max. (S1 - S6) / Max. Power.(S1 - S6)	24 kW @ 4000 Rpm (S1) / 30 kW @ 4000 Rpm (S6)
Coppia max. (S1 - S6) / Max. Torque (S1 - S6)	56,6 Nm (S1) / 70,7 Nm (S6)
Corrente (S1 - S6) / Current (S1 - S6)	54A (S1) / 74A (S6)
Tensione / Voltage	380V
Rotazione / Rotation	CW - CCW
Azionamento / Supply	Con inverter / By inverter
Sensoristica / Sensors	S1 Afferraggio utensile / S1 Tool lock S2 Pinza aperta / S2 Open clamp S3 Rotazione albero / S3 Spindle rotation S5 Ritorno pistone / S5 Piston back
Encoder	ENCODER SIN/COS 1Vpp 256 IMPULSI/GIRO + TACCA ZERO ENCODER SYN/COS 1Vpp 256 CYCLES/REV + REFERENCE MARK
Peso / Weight	44 kg